

# T-GRID Integrated Luminaire

Ideal for office buildings, medical, health and educational buildings, hotels, airports and more. Create your own custom look.

Replaces Standard T-BAR Cross Tees.

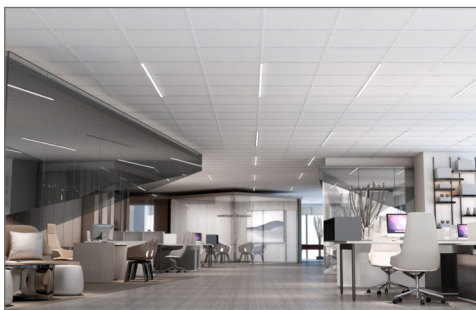

Slim Profile  
0.48" thickness

15/16"

Seamless Integration  
into suspended ceilings allows  
unique and elegant architectural  
lighting designs



Frosted Lens and 8 ft  
Power Cable with RJ45  
Jack

1 power supply required for 3 pieces of T-Bar.

Optional 9/16" Clear Diffuser and Lens Diffuser available (sold separately).



Power Supply  
Ordered Separately

# T-GRID Integrated Luminaire

Suitable for office buildings, medical, health and educational buildings, hotels, airports and more



PRODUCT #	WATTS	VOLTAGE	CCT	LUMENS	FINISH	LENGTH
TBAR2-DM-35K	10W	120-277V	3500K	1,300 lm	Silver	2 ft
TBAR2-DM-40K	10W	120-277V	4000K	1,150 lm	Silver	2 ft
TBAR4-DM-35K	20W	120-277V	3500K	2,600 lm	Silver	4 ft
TBAR4-DM-40K	20W	120-277V	4000K	2,400 lm	Silver	4 ft
TBAR-PS-30W	Power Supply for TBAR2-DM-35K and TBAR2-DM-40K					
TBAR-PS-60W	Power Supply for TBAR4-DM-35K and TBAR4-DM-40K					
<i>Special Order</i>	Clear Diffuser 9/16"					
<i>Special Order</i>	Lens Diffuser					

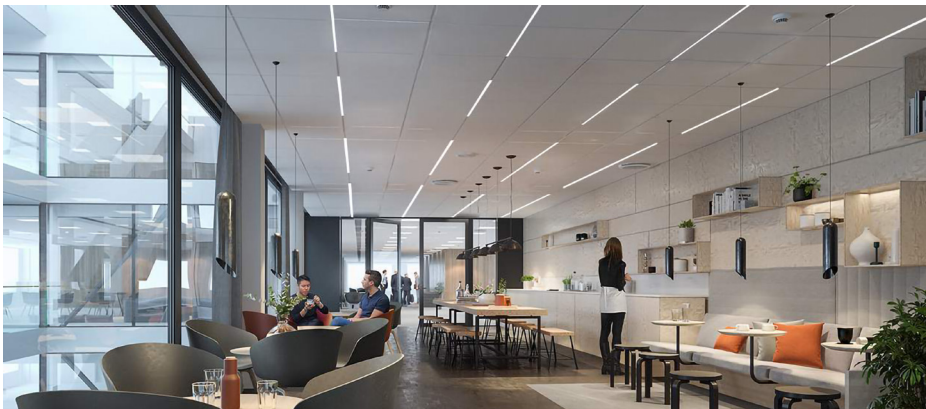

## Power Supply

1 power supply is required for 3 pieces of T-Grid lighting

TBAR-PS-30W (for 2ft T-Bar)  
TBAR-PS-60W (for 4ft T-Bar)



Ordered Separately

## Diffusers (Special Order)

### Clear Diffuser 9/16"

Provides beam angle options (70° and 90°) for controlled light distribution.



### Lens Diffuser

Complete with a reflector for applications where a concentrated angle of light is desired on task areas (85° beam angle).

