

10W Streamline Flood Light

streamline
designer flood light series

Ideal for landscape lighting, architectural flood lighting, and interior wall washing



TECHNICAL DATA



LIGHT SPECIFICATIONS

Lumens	1,089
Efficacy	110.66 lm/W
CCT	4,000K
Beam angle	110°
CRI	82.7
Rated hours	35,000
Warranty	10-year

ELECTRICAL

Wattage	10W
Voltage	120-277V
Power factor	0.98
THD	16.91%
Operating temp	-20° to 40°C

APPROVALS AND LISTINGS

cUL	E482965
DLC	PSHZDGDY

CONSTRUCTION

Housing	Die-cast aluminum
Finish	Powder coat
Colour	White
IP rating	IP65
Weight	0.97 lbs
Carton qty	40

DIMENSIONS

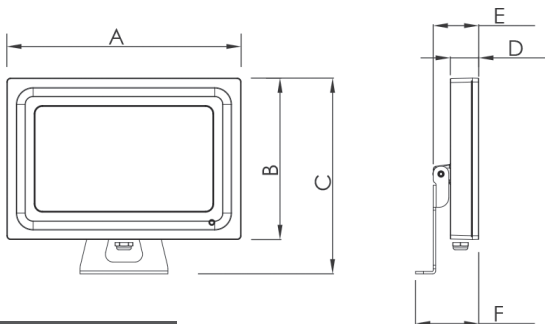

FL02-10W

Unit: mm | Tolerance: ± 1 mm

- A: 135 B: 90
- C: 123 D: 19.5
- E: 34 F: 52
- G: 44 H: 14.5
- I: 6.5 J: Ø 6.5

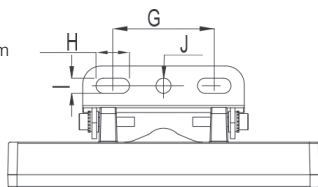

NOTES

50cm cable included

DISTRIBUTION CURVE FLUX/TEMP

