



200W High Bay, HV

Pendant style High Bay with Premium Performance
Optional microwave motion sensor, aluminum reflector, PC reflector,
anti-glare kit, and yoke available

Polyester
Powder Coat
Finish

High-impact
tempered glass with
high light transmittance

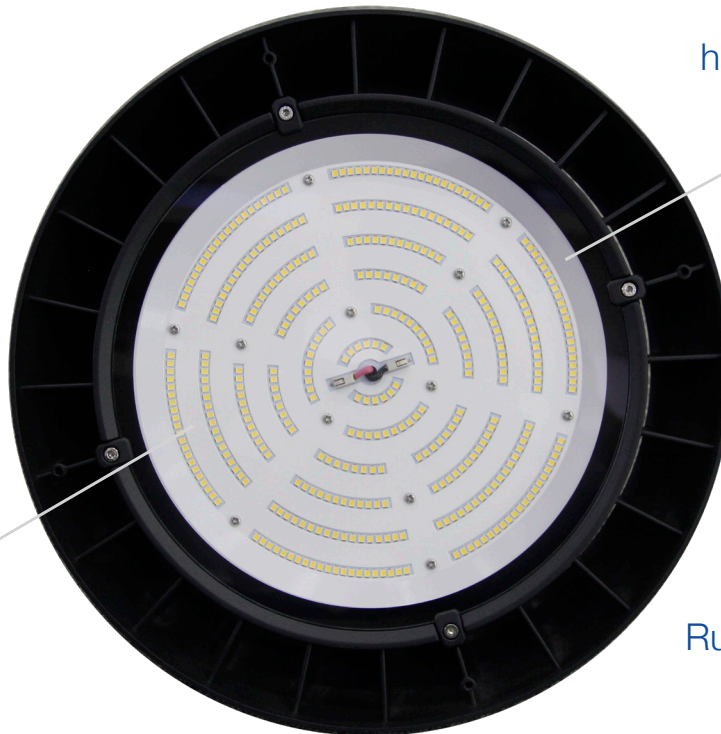

IP65

Rugged Cast Aluminum



Shown with optional
Dimmable Motion Sensor



Shown with optional
Frosted Polycarbonate
Lens



Shown with optional
Clear Polycarbonate
Lens

0-10V
Dimmable



TECHNICAL DATA



LIGHT SPECIFICATIONS

Lumens	26,293
Efficacy	133.87 lm/W
CCT	4000K
Beam angle	110°
CRI	82.9
Dimmable	0-10V
Rated hours	50,000
Warranty	5-year

APPROVALS AND LISTINGS

cUL	E482965
DLC PREMIUM	PLLQ62WEN1RL

DIMENSIONS

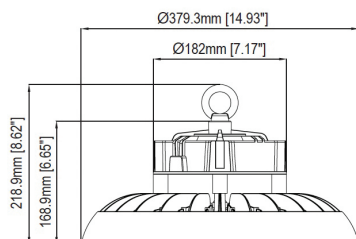

ILLUMINANCE AT A DISTANCE

	Illuminance at a Distance	
	Center Beam fc	Beam Width
3.33M	81.5 fc	9.53 M 9.59 M
6.67M	20.4 fc	19.06 M 19.18 M
10.00M	9.07 fc	28.59 M 28.78 M
13.33M	5.10 fc	38.12 M 38.36 M
16.67M	3.26 fc	47.65 M 47.96 M
20.00M	2.27 fc	57.18 M 57.55 M

■ Vert. Spread: 110.1°
■ Horiz. Spread: 110.4°

ELECTRICAL

Wattage	200W
Voltage	277-480V
Power factor	0.89
THD	12.75%
Operating temp	-40 to 40°C

CONSTRUCTION

Housing	Cast Aluminum
Finish	Powder Coat
Colour	Black
IP rating	IP65
Weight	13 lbs
Carton qty	1

INSTALLATION INSTRUCTIONS

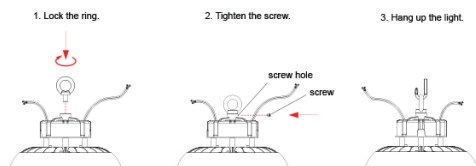

ACCESSORIES AVAILABLE

Microwave Motion Sensor Kit	HBP-MMS-KIT-HV
Aluminum Reflector	HBP-AL-REF-B
PC Reflector	HBP-PC-REF-B
Anti-glare Kit	HBP-AGK-B
Yoke	HBP-YK-B
Frosted Polycarbonate Lens	HBP-FR-LENS-B
Clear Polycarbonate Lens	HBP-PC-LENS-B