



240W High Bay, HV

Pendant style High Bay with Premium Performance

Optional microwave motion sensor, aluminum reflector, PC reflector, anti-glare kit, and yoke available

Polyester
Powder Coat
Finish

High-impact
tempered glass with
high light transmittance

IP65

Rugged Cast Aluminum

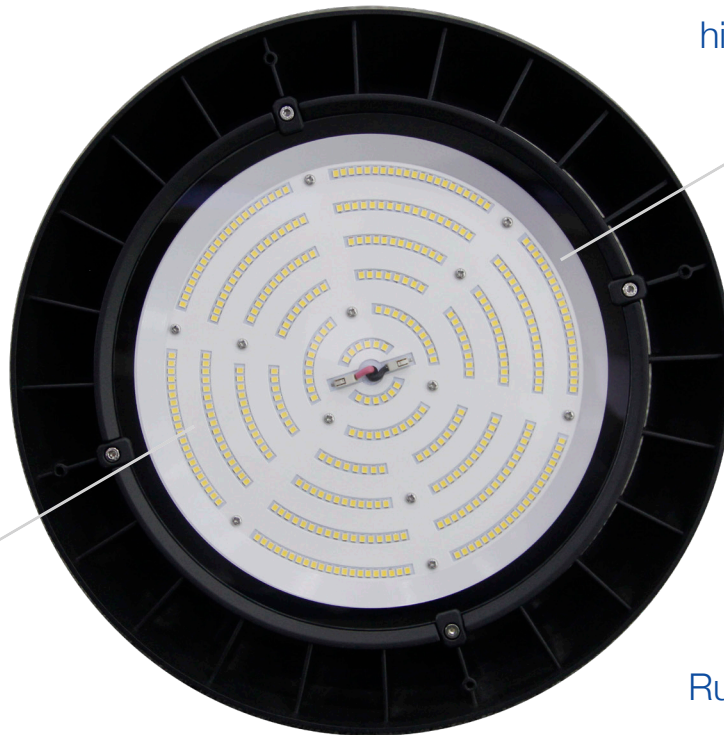

0-10V
Dimmable



Shown with optional
Dimmable Motion Sensor



Shown with optional
Frosted Polycarbonate
Lens



Shown with optional
Clear Polycarbonate
Lens

TECHNICAL DATA



LIGHT SPECIFICATIONS

Lumens	31,089
Efficacy	132.12 lm/W
CCT	4000K
Beam angle	110°
CRI	82.9
Dimmable	0-10V
Rated hours	50,000
Warranty	5-year

APPROVALS AND LISTINGS

cUL	E482965
DLC PREMIUM	PLTCXS3OL2W6

DIMENSIONS

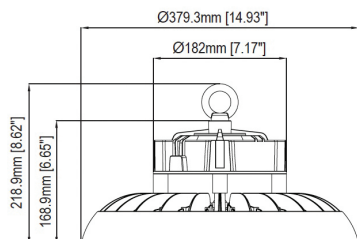

ILLUMINANCE AT A DISTANCE

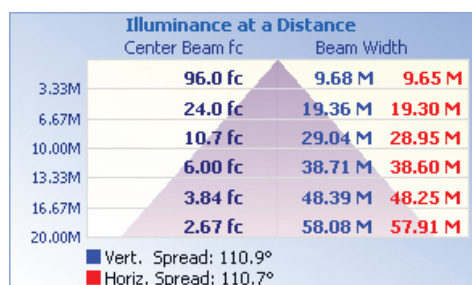

ELECTRICAL

Wattage	240W
Voltage	277-480V
Power factor	0.88
THD	13.6%
Operating temp	-40 to 40°C

CONSTRUCTION

Housing	Cast Aluminum
Finish	Powder Coat
Colour	Black
IP rating	IP65
Weight	13 lbs
Carton qty	1

INSTALLATION INSTRUCTIONS

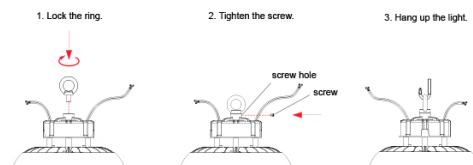

ACCESSORIES AVAILABLE

Microwave Motion Sensor Kit	HBP-MMS-KIT-HV
Aluminum Reflector	HBP-AL-REF-B
PC Reflector	HBP-PC-REF-B
Anti-glare Kit	HBP-AGK-B
Yoke	HBP-YK-B
Frosted Polycarbonate Lens	HBP-FR-LENS-B
Clear Polycarbonate Lens	HBP-PC-LENS-B