



# 240W High Bay, HV

Pendant style High Bay with Premium Performance

Optional microwave motion sensor, aluminum reflector, PC reflector, anti-glare kit, and yoke available

Polyester  
Powder Coat  
Finish

High-impact  
tempered glass with  
high light transmittance

IP65

Rugged Cast Aluminum

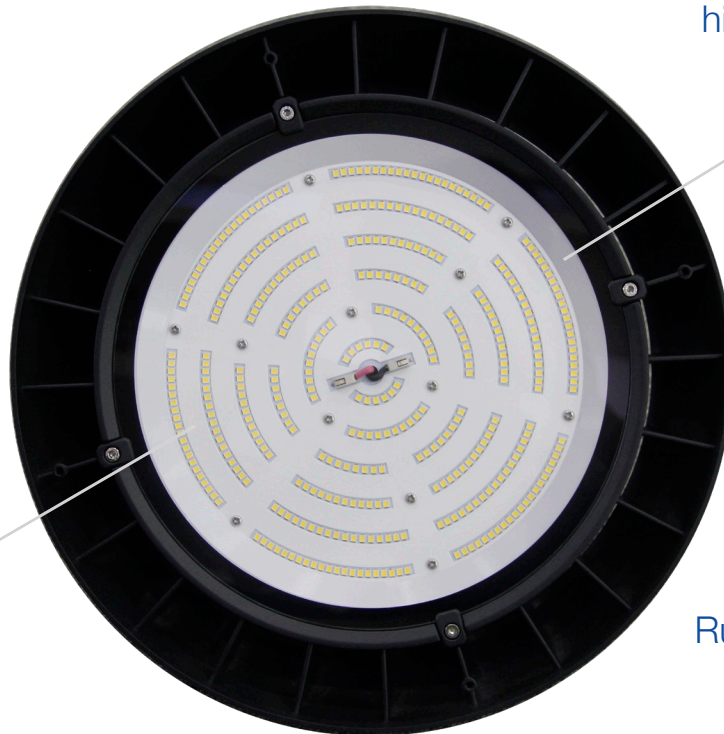

0-10V  
Dimmable



Shown with optional  
Dimmable Motion Sensor



Shown with optional  
Frosted Polycarbonate  
Lens



Shown with optional  
Clear Polycarbonate  
Lens

## TECHNICAL DATA



### LIGHT SPECIFICATIONS

Lumens	32,151
Efficacy	134.86 lm/W
CCT	5000K
Beam angle	110°
CRI	80
Dimmable	0-10V
Rated hours	50,000
Warranty	5-year

### APPROVALS AND LISTINGS

cUL	E482965
DLC PREMIUM	PLOJ7QVBDZST

### DIMENSIONS

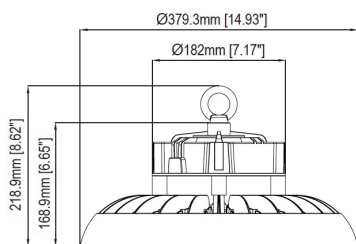

### ILLUMINANCE AT A DISTANCE

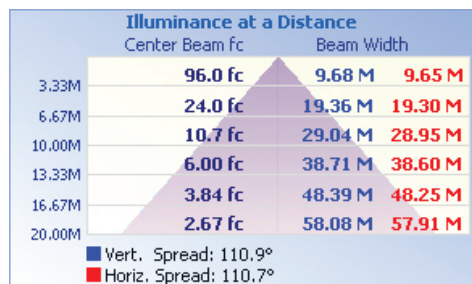

### ELECTRICAL

Wattage	240W
Voltage	277-480V
Power factor	0.88
THD	15%
Operating temp	-40 to 40°C

### CONSTRUCTION

Housing	Cast Aluminum
Finish	Powder Coat
Colour	Black
IP rating	IP65
Weight	13 lbs
Carton qty	1

### INSTALLATION INSTRUCTIONS

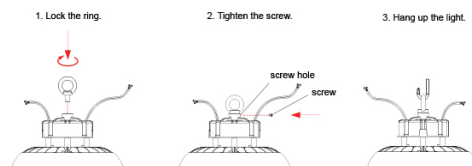

### ACCESSORIES AVAILABLE

Microwave Motion Sensor Kit	HBP-MMS-KIT-HV
Aluminum Reflector	HBP-AL-REF-B
PC Reflector	HBP-PC-REF-B
Anti-glare Kit	HBP-AGK-B
Yoke	HBP-YK-B
Frosted Polycarbonate Lens	HBP-FR-LENS-B
Clear Polycarbonate Lens	HBP-PC-LENS-B